

Barceló Punta Umbría Beach Resort



UNIQUE NATURAL ENVIROMENT, SURROUNDED BY ENEBRALES NATURAL RESERVE
CONVENTION CENTER OF 4.000sqm
IN A VIRGIN BEACH SEA FRONT
SPA & WELLNESS OF 2.000sqm
7 GOLF COURSES NEARBY

INTRODUCTION

In the heart of “**Paraje de los Enebrales**” and “**Marismas del Odiel**”. The Hotel Barceló Punta Umbría Beach Resort open its doors in **June 2007**.

Built in a typical **Andalusian style, modern and elegant**, a beautiful place with a fantastic natural surrounding. The region is well known around the world for the cured ham (Jamón), as well as, fish and seafood.

Situated in the fishing town of Punta Umbría **at 15km of Huelva capital and 45 km from the portuguese Algarve.**

Bus stop a few metres from the hotel, train station in Huelva capital and two nearby international airports, Seville and Faro.



In this dossier you will find all the information about capacity and measure of conference rooms, hotel facilities, leisure activities and events. The Resort provides the perfect place for your business and leisure.

Barceló Punta Umbría Beach Resort

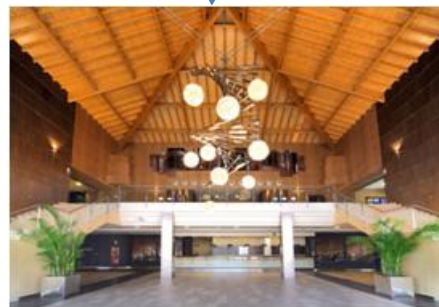
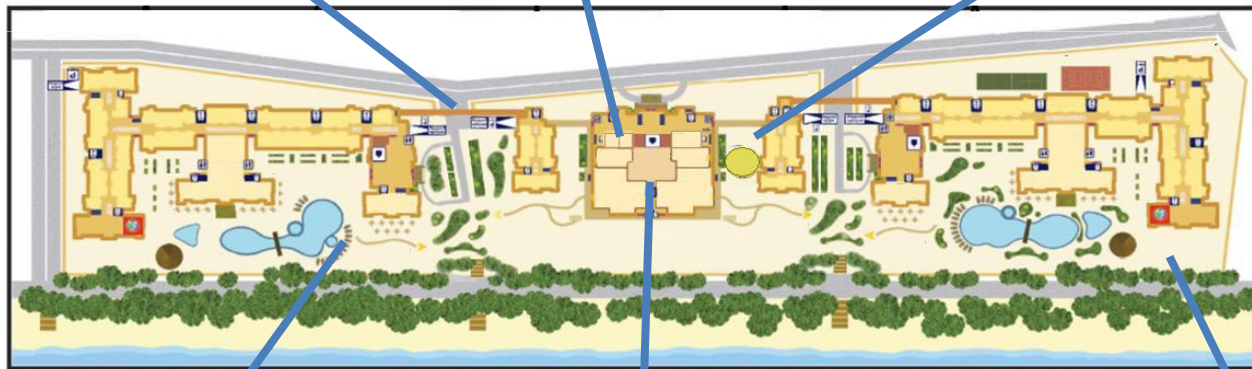

BARCELÓ AUDITORIUM

1.100sqm with 5,90m ceiling high, existing stage 14x10m and private terrace of 300 sqm facing the natural park. It provides a stellar program, featuring local and international artists:

BARCELÓ AUDITORIUM

- Hosting regional events
- Flamenco groups
- Guitarist, singers
- Portuguese night: Fados
- Music groups
- Live entertainment
- Dance companies
- Magic show



Close to the hotel with a wide program of performances and activities around the year

Punta Umbría Theater:

- Theater groups
- Dance companies
- Music groups
- Literature
- Cultural programs



SPA & WELLNESS

Barceló
Punta Umbría
Beach Resort

2.000sqm of modern facilities and a fantastic natural surroundings makes this place a perfect retreat for health and wellness treatments

The most updated equipment :

- Hot tub
- Sauna
- Steam room
- Therapeutic showers
- Heated Indoor pool

Beauty Treatment rooms :

- Relaxation massage
- Therapeutic massage
- Lymphatic drainage
- Reflexology
- Shiatsu massage
- Combination massage
- Aromatherapy
- Body wraps:
 - Muds & seaweed
 - Detoxifying & Hydrating
 - cellulite treatments
- Facial treatments:
 - rejuvenating
 - Radiance facial
 - Collagen facial



SPORT FACILITIES

Resort facilities:

- Padel court
- Multi purpose court
- 2.000sqm outdoor pool for adults & children
- Gym

Five minutes away, **Punta Umbría** has top quality sport facilities

Athletics track	400m/ 8 lanes synthetic material sportflex
Football field	60x100m. Grass 58x65m. Synthetic grass
2 Paddle court	10x20m Synthetic grass
2 Tennis court	18,29x36,57m. Polish concrete
Multi purpose court	22x44m. Polish concrete
Canoeing school	12kmx300m on the Odiel Marshes Angar



FOOD & BEVERAGE FACILITIES

The Resort has **4 buffet restaurants, El Calé, Estero, Cormoranes and Bambú** with a wide range of menus, combining internacional, national and andalusian cuisine.

These 4 Buffet become Themed Buffets at Dinner Time.

Estero: Market Style Buffet

Cormoranes: American Tex-Mex Buffet

Calé: Italian style Buffet

Bambú: Oriental style Buffet

Our bars:

- **Lobby Bar Isla Saltés**
- **Lobby Bar William Martin**
- **Lobby Bar El Portil**
- **Pool Bar La Retama**
- **Pool Bar La Canaleta**

Set menus, we offer an extensive menu choices. Our experienced professionals are willing to assist you.

We have the ability to cater from served menus to cocktails in our limitless available areas.



Barceló Punta Umbría Beach Resort

Estero: Market Style Buffet



Cormoranes: American Tex-Mex Buffet

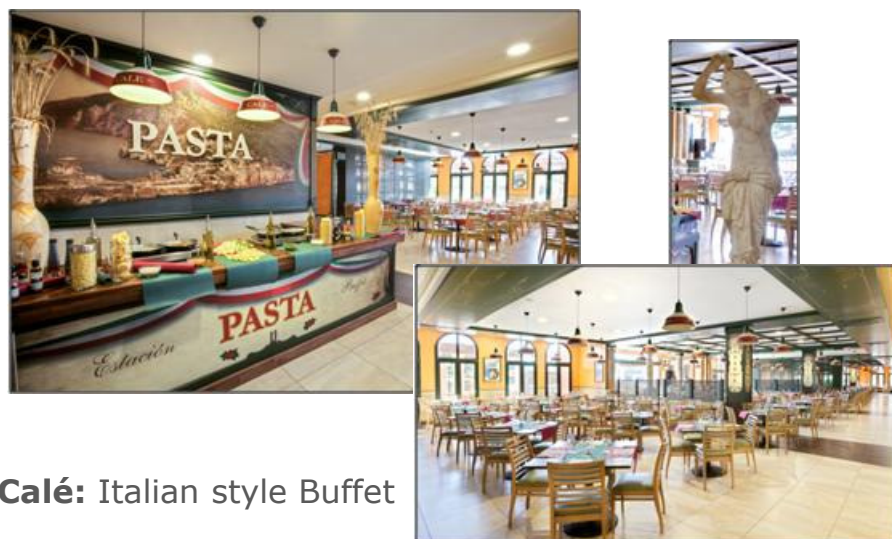

Calé: Italian style Buffet



Bambú: Oriental style Buffet

GASTRONOMY

The different cultures established in the province provided this place with a richness gastronomy. To eat in Huelva is synonym of eating well. We can highlight in the area:

Fish and seafood, **the white prawn**, boquerones, acedías, chocos, coquinas etc.

Meat, **the Iberian pork**, a very tasty meat

Mushrooms, a wide range in Huelva countryside, the most typical is **gurumelo**

Sweets with arab influence, almonds and honey are the base for cakes and cookies such as alfajores, polvorones, etc.

Olive oil, is the base of all the andalusian dishes. The province of Jaen is the largest producer of olive oil in the world

We can not forget **the strawberries** exported to all around Europe and very important for Huelva 's economy. They are flavorfull with high levels of vitamin C and are a source for antioxidants



TECHNICAL DATA

Category
Capacity

4 ****

1.200 rooms:

- Smoking/ non-smoking
- Disabled facilities
- Air conditioning / central heating
- Mini bar
- Direct dial telephone
- In suite bathroom
- Complimentary amenities
- Hair dryer and mirror
- Secure digital safe
- LCD/ Plasma television with satellite channels
- Room service
- Suites
- Junior suites

Address
Telephone
Fax
E-mail
Website

Avenida Del Decano s/n. 21100 Punta Umbría (Huelva)

(+34) 959 495 900

(+34) 959 495 901

puntaumbriaresort@barcelo.com / r.blanco@barcelo.com / huelva.cci@barcelo.com

www.puntaumbriabeachresort.com

Located

Punta Umbria (Costa de la Luz)

At 15km from Huelva

How to arrive

Seville airport 115 km, Faro airport 130km

Train station at 15 km

Bus station at 300 m

By road A49 from Sevilla

by road A22 from Portugal



Food & Beverage

- 4 Themed restaurants
- 3 Lobby Bars
- 2 Pool Bars

General facilities

- Laundry facilities
- Water and sports activities
- Entertainment program
- Car park with 1.200 spaces
- Cybercorner
- Maxiclub and miniclub
- Wake up call
- Foreign currency exchange
- Car rental
- Bicycle rental
- Shopping center at 100m from hotel
- Outdoor sport activities (15 km of bicycle path from the hotel)
- Cultural routes to Huelva province

Hotel facilities

- Gym
- Spa & Wellness (2.000sqm)
- Beauty room
- Souvenir shop
- Indoor & Outdoor pool for adults and children
- Sport facilities
- Barceló Huelva Convention Center

ENVIRONMENT

Huelva received the last ray of sunlight of south Spain, 3.200 hours of Sun the perfect invitation to enjoy this place.

Beaches. Punta Umbría has 13 km of golden sand beaches surrounded by a great natural heritage.

Nature. The hotel is settled at a very special place, Enebrales Natural Park where you'll find two protected species, chameleons and juniper grove.

GOLF COURSES

The hotel has 7 golf courses nearby, four of them within 18 km.

- **Club de Golf Bellavista.** With 18 holes **10km** from the Resort
- **La Monacilla Golf Club.** With 18 holes **10km** from the Resort
- **Nuevo Portil.** With 18 holes. **8km** from the Resort
- **El Rompido Golf.** Two routes (north and south) 18 holes each one. **12km** from the Resort
- **Club de Golf Islantilla.** With 27 holes. **45km** from the Resort
- **Club de Golf Isla Canela.** With 18 holes. **60km** from the Resort
- **Golf Dunas de Doñana.** With 18 holes. **65km** from the Resort



COMPLEMENTARY ACTIVITIES

Visit and business lunches organization at :

Ranch:

- Landscape visit
- Bullfight with young bulls
- Countryside meals



Ham factory:

- Landscape visit
- Sausage elaboration
- Product sample

Wine culture:

- Wine cellar visit
- Wine tasting
- Lunches
- Guitarist



What to do? What to see?

- El Rocío (Rocío pilgrimage)
- Columbus places
- Sierra de Aracena and Picos de Aroche
- Cave of Wonders
- Riotinto mines
- Doñana National park visits
- Odiel marshes visits
- Boat routes
- Ride horses
- Horses exhibitions
- 4x4 routes
- Quads
- Aventure
- Sailing
- Canoeing
- Archery
- Archaeology visits
- Trekking



And more...



Barceló
Punta Umbría
Beach Resort



Barceló Punta Umbría Beach Resort



Barceló Punta Umbría Beach Resort

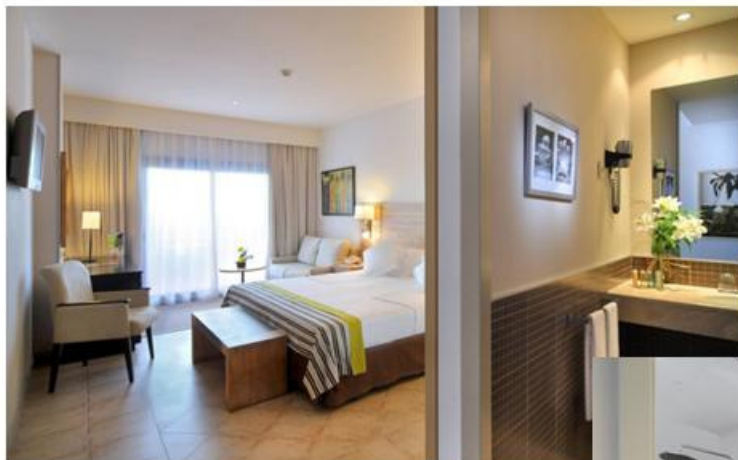

HALLS & LOUNGES GENERAL PLAN

Ground floor

- 1** Santa María I
- 2** Santa María II
- 3** Lobby Bar William Martin
- 4** Restaurant Focaccia
- 5** Restaurant Dehesa de Huelva
- 6** American Buffet Cormoranes
- 7** Market Buffet El Estero

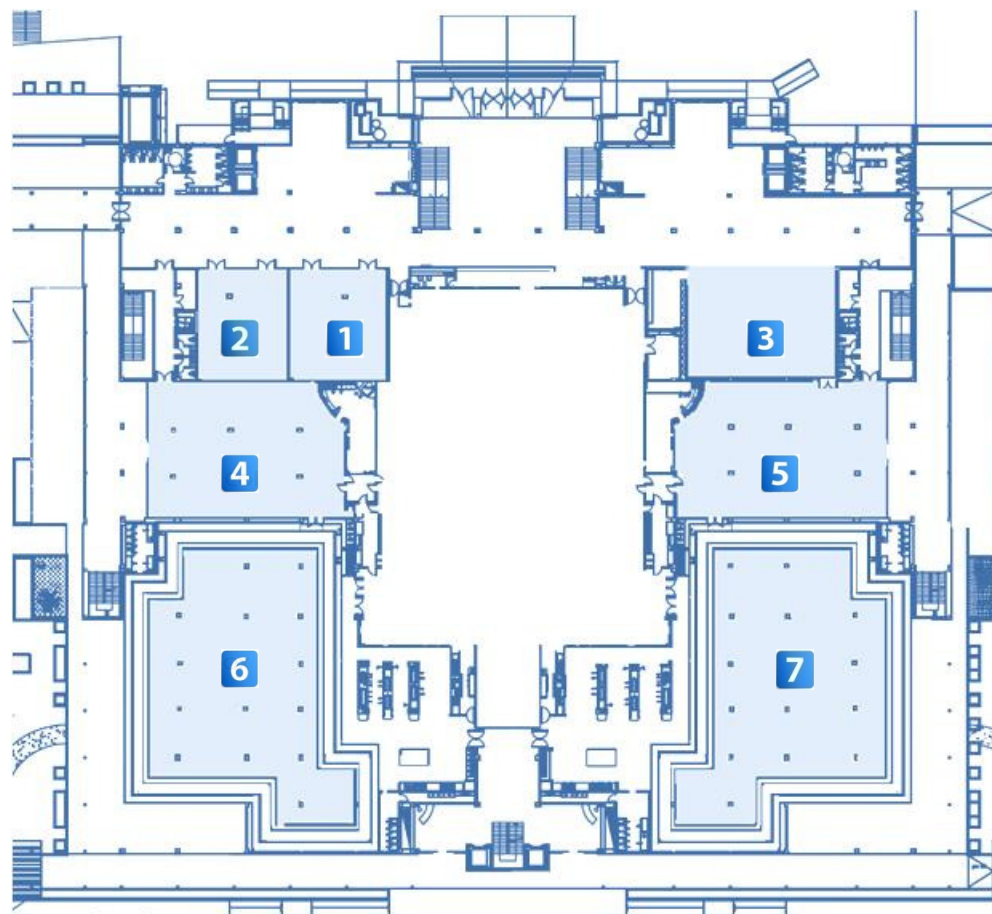

SANTA MARÍA HALLS

- 1** Santa María I
- 2** Santa María II

11,8 m

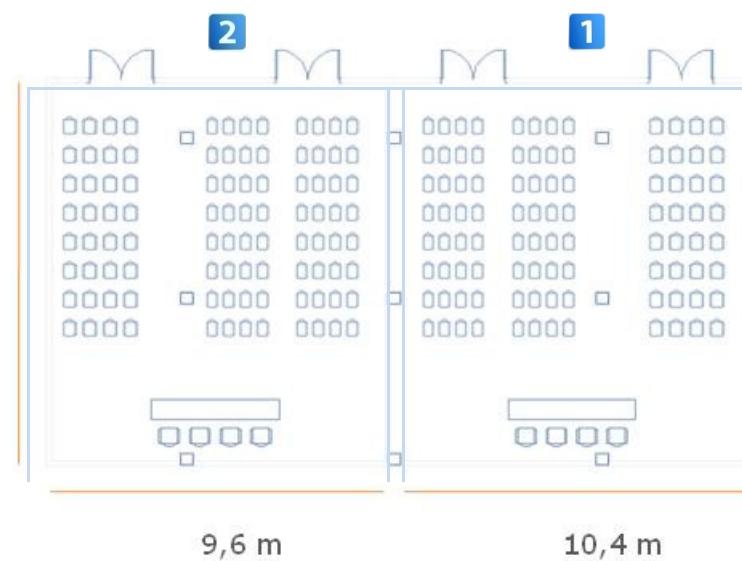

HALLS & LOUNGES GENERAL PLAN

First floor

- 1** Colón I
- 2** Colón II
- 3** Colón III
- 4** Barceló Auditorium
- 5** Pinta I
- 6** Pinta II
- 7** Niña I
- 8** Niña II
- 9** Niña III

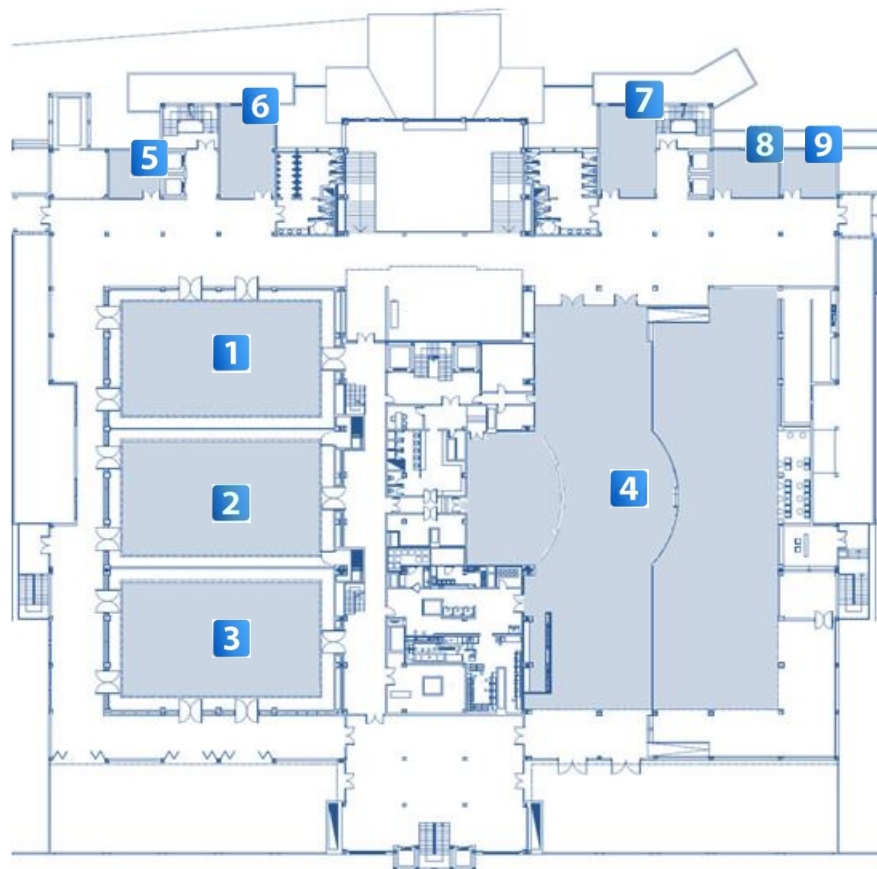

COLÓN

- 1** Colón I
- 2** Colón II
- 3** Colón III

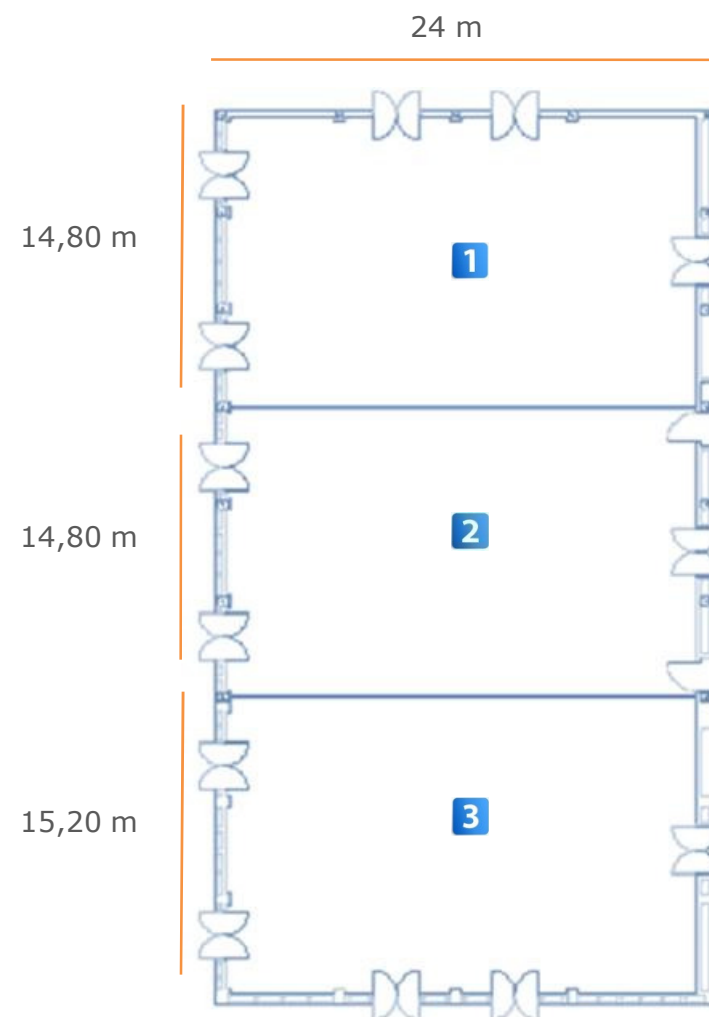

Barceló
Punta Umbría
Beach Resort

FOYER

1.200sqm. Cocktail capacity for 1.000 people

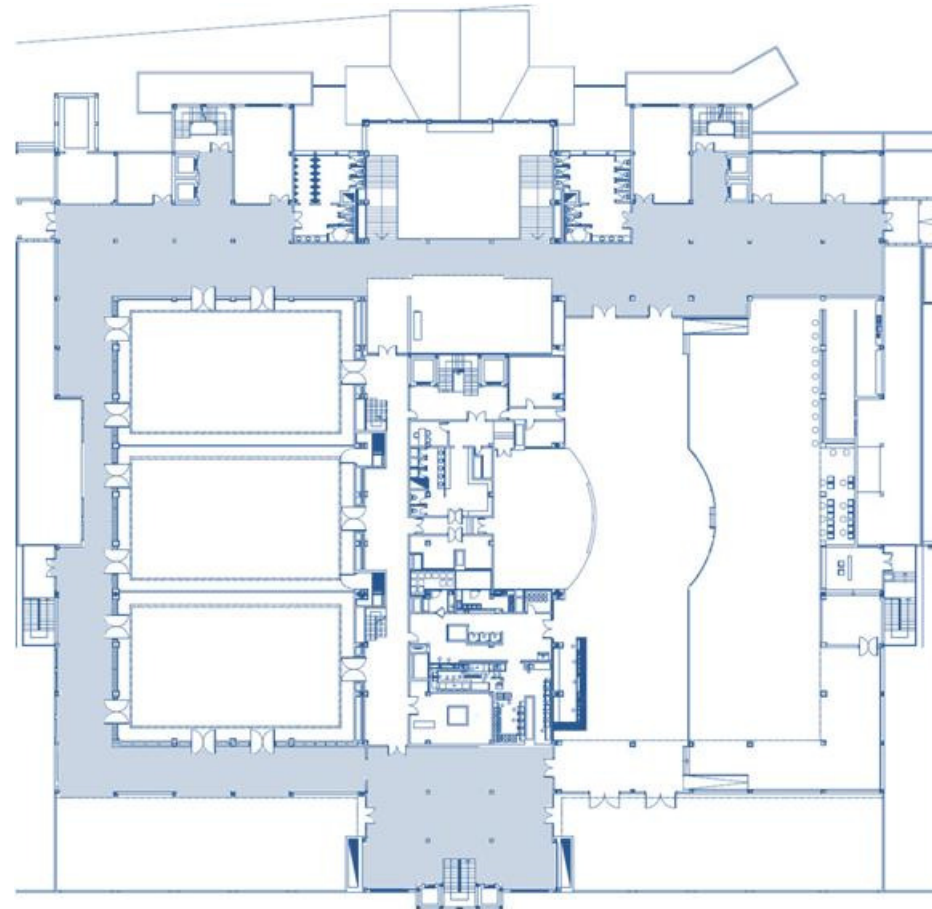

FOYER & TERRACE

The liveliest and most attractive areas in the Resort are:

- **East and West terrace** with 310sqm each one and cocktail capacity for 344 people

Two ideal areas, setting the scene for important events like trade shows, monographic exhibitions, product presentations, cocktail events and dinners.

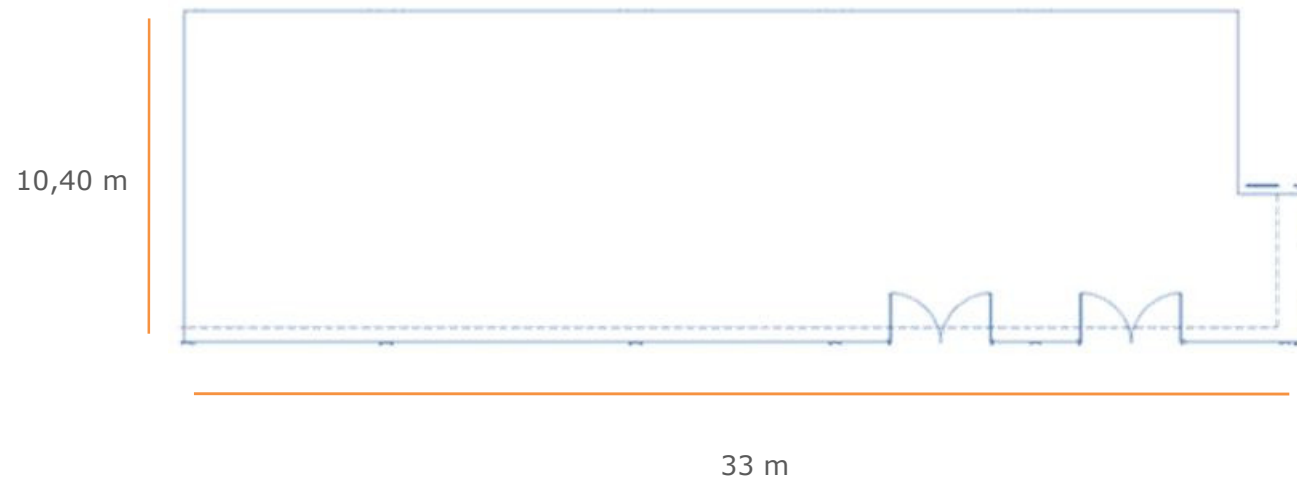

BARCELO AUDITORIUM

Technical equipment.

FRONTAL LIGHTS

- 24 PAR 64 1000w
- 1 ESTROBO 2000W
- 4 MOVING HEADS PROSPOT 250
- 2 BLACK LIGHTS PROYECTORS 400W

SCENE FIRST ROW

- 12 PC 1.000W
- 4 MOVING HEADS PROSPOT 250
- 2 BLACK LIGHT PROYECTORS 400W
- 2 ESTROBO 2000W

CENTRAL LIGHT

- 4 SCANNER (LIGHT EFFECTS)
- 6 FOCUS PAR 64 DMX
- 4 PC 1.000W
- 16 PAR 64 1.000W

BACK LIGHTS

- 16 ASIMETRIC PANORAMA FOCUS 1000W
- 4 FOCUS PAR 64 DMX
- 12 PAR 64 1000W

ASIDES

- 2 SMOKE MACHINE
- 1 CANYON DMX

SOUND

- 2 SUBWOOFER JBL 1000W
- 4 SPEAKER JBL
- 4 2WAY BOX JBL

MISC

- 1 CICLORAMA PVC GREY 14x4,5m
- 2 PROYECTION SCREENS 240X180CM

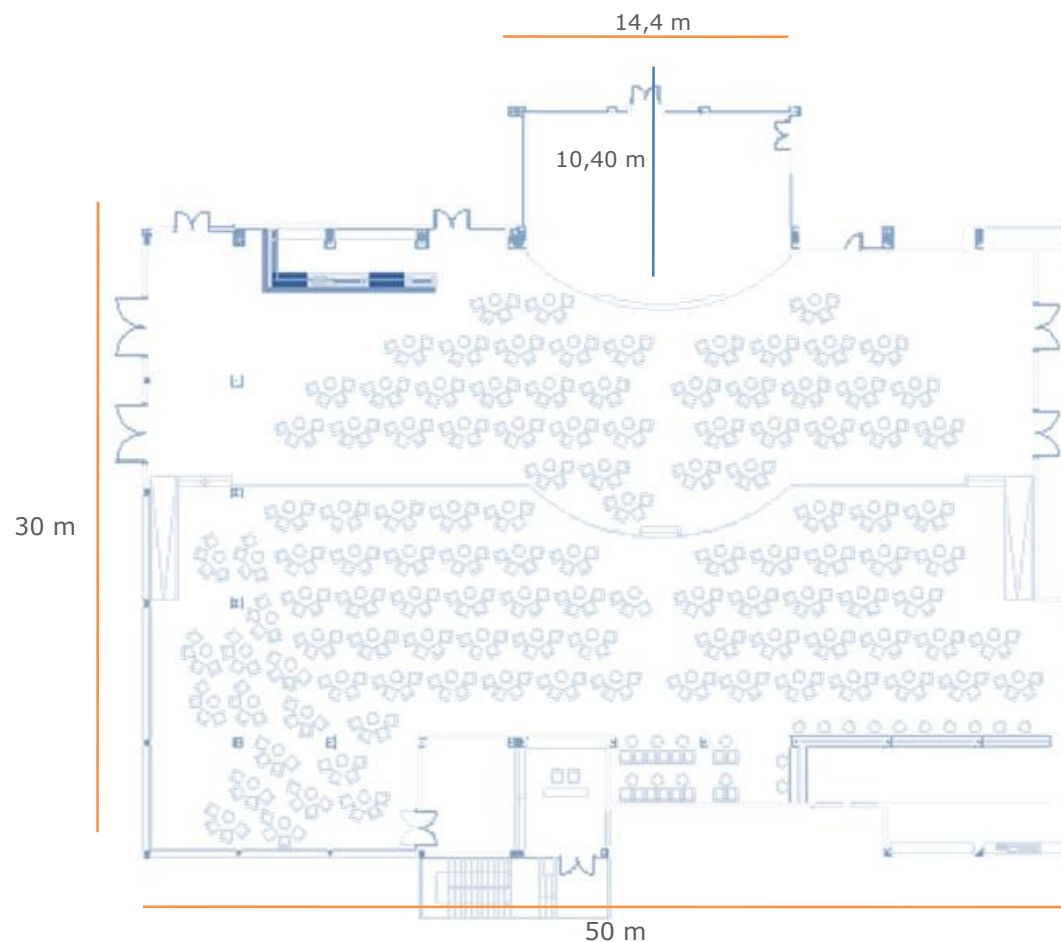

LA PINTA HALLS

1 La Pinta I

2 La Pinta II

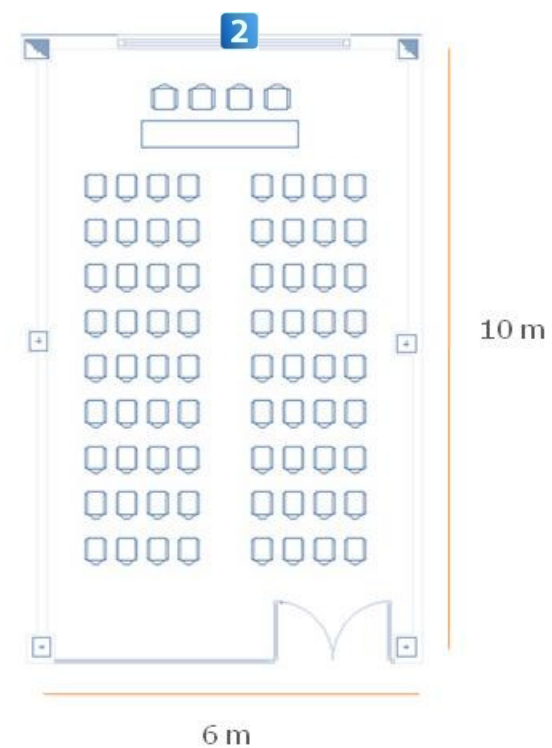
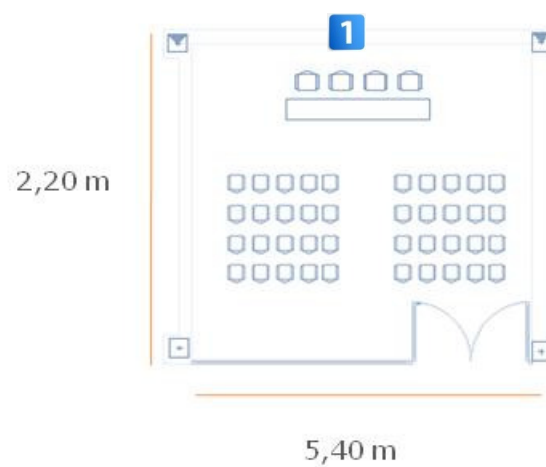

LA NIÑA HALLS

- 1** La Niña I
- 2** La Niña II
- 3** La Niña III

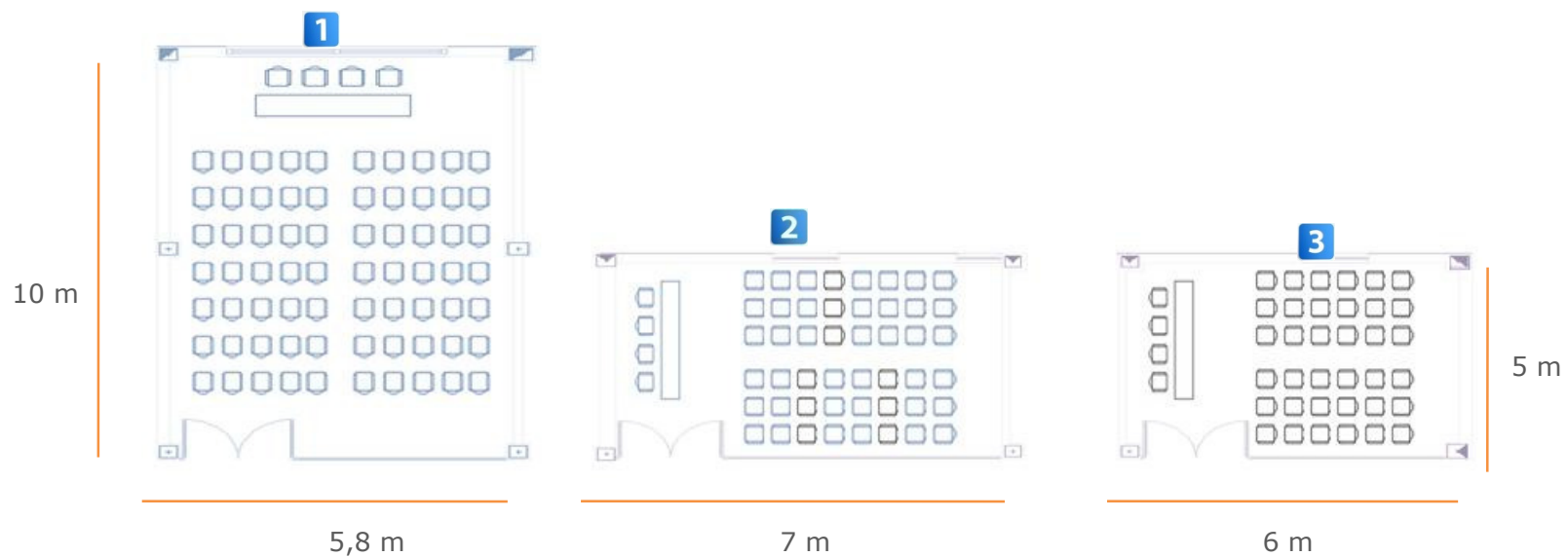

BREAKOUT ROOMS

- 1** Colina
- 2** Gallega
- 3** Marigalante
- 4** Santa Clara
- 5** La Rábida
- 6** Fraila
- 7** Subcomisión I
- 8** Subcomisión II
- 9** Subcomisión III



BREAKOUT ROOMS

- 1** Colina
- 2** Gallega
- 3** Marigalante
- 4** Santa Clara
- 5** La Rábida
- 6** Fraila
- 7** Subcomisión I
- 8** Subcomisión II
- 9** Subcomisión III

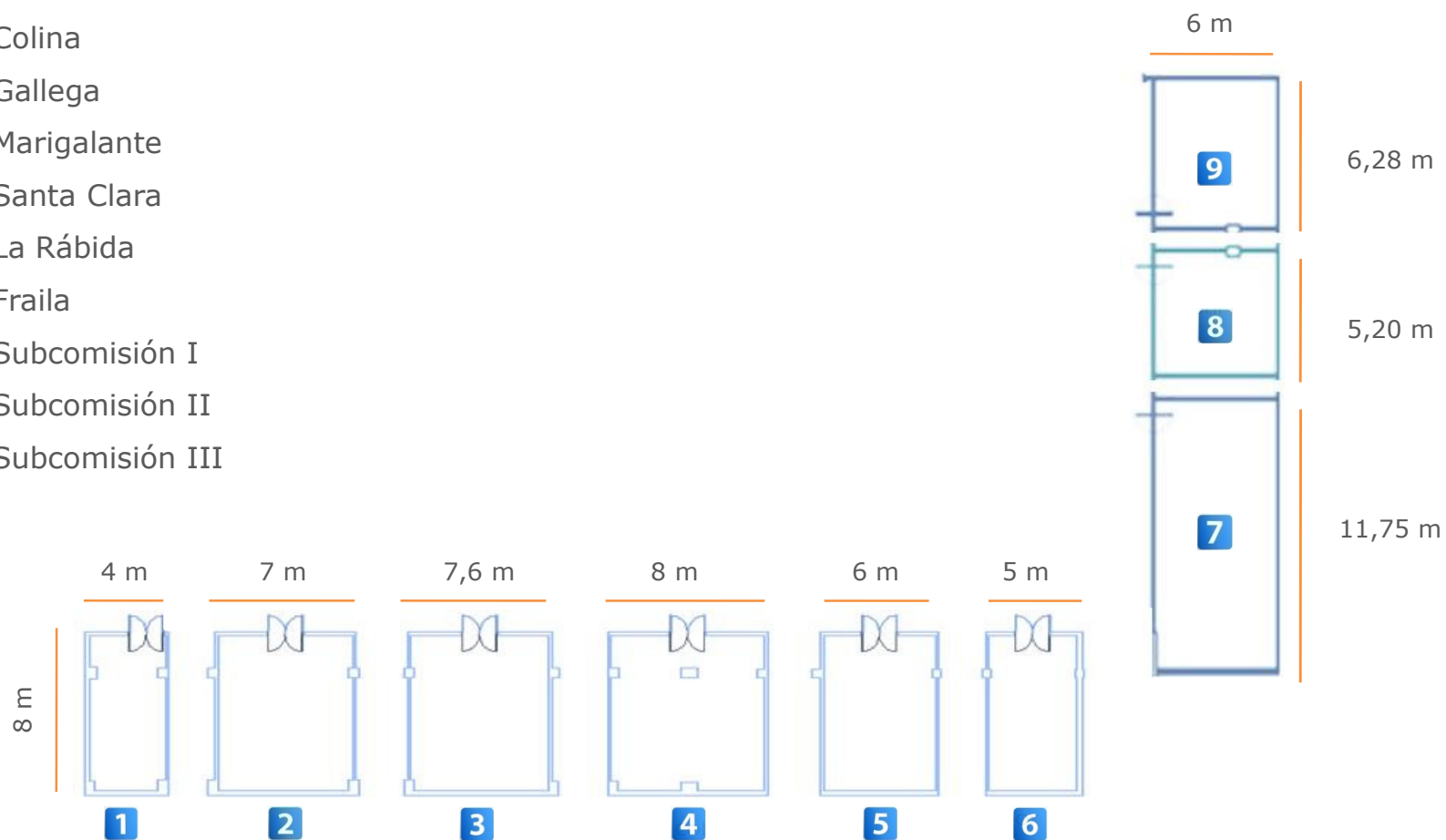

Barceló

Punta Umbría Beach Resort

Salón Meeting Room Raum	m ² /sqm	Ancho x Largo Width x Length Breite x Länge	Altura Height Höhe	Luz Natural Natural Light Tageslicht	Banquete Banquet Bankett	Cóctel Cocktail Cocktail	Escuela School Schule	Teatro Theatre Theater	U U Shape U-Tafel	Imperial Imperial Block
Barceló Auditorium	1176	24 x 49	6	✓	700	1200	900	1500	-	-
Cristóbal Colón	1149,54	24 x 44,8	6	✗	700	1200	900	1500	-	-
C. Colón I	355	24 x 14,8	6	✗	300	420	300	500	60	65
C. Colón II	355	24 x 14,8	6	✗	300	427	300	500	60	65
C. Colón III	364	24 x 15,20	6	✗	300	431	300	500	60	65
Santa María I	113.3	9,6 x 11,8	2.9	✗	67	133	63	120	-	-
Santa María II	122	10,4 x 11,8	2.9	✗	67	133	63	120	-	-
Pinta I	30	6 x 5	2.7	✓	17	33	16	30	9	11
Pinta II	60	6 x 10	2.7	✓	34	63	32	61	25	30
Niña I	58	5,8 x 10	2.7	✓	32	64	31	58	25	30
Niña II	35	7 x 5	2.7	✓	20	40	19	36	15	18
Niña III	30	6 x 5	2.7	✓	22	20	21	24	9	11
Colina	32	4 x 8	3	✗	18	35	17	32	9	11
La Gallega	56	7 x 8	3	✗	31	62	29	56	25	30
Marigalante	56	7 x 8	3	✗	31	62	29	56	25	30
Santa Clara	64	8 x 8	3	✗	36	71	34	64	25	30
La Rábida	48	6 x 8	3	✗	27	53	25	48	20	25
La Fraila	40	5 x 8	3	✗	18	36	17	32	9	11
Subcomisión I	70	6 x 11,8	2,7	✓	39	78	37	70	25	30
Subcomisión II	30	6 x 5,20	2,9	✓	17	33	16	30	9	11
Subcomisión III	38	6 x 6,30	2,9	✓	21	42	20	38	9	11
Foyer	700	2,3 x 51,4	4	✓	389	1000	-	-	-	-
Terraza Auditorium	494,14	47 x 10,5	-	✓	172	344	-	-	-	-
Terraza Colón	306,04	32 x 10,2	-	✓	172	344	-	-	-	-
Focaccia *	280	10 x 14	2,9	✓	100	250				
Dehesa de Huelva *	280	10 x 14	2,9	✓	100	250				
Converted dormitory	42		2,74	✓	12		15	30	12	15